

This supplement covers installation of the half and full screen for Wood pocket windows. Please follow all of the steps in the full set of installation instructions and install the screen after all other instructions are complete.

### NEEDED TOOLS

- Pencil
- Hammer
- Screwdrivers
- Drill with 1/4" bit

### FULL SCREEN

1. On the exterior, position one hanger on the window frame next to the stop at the top of the window as shown. Nail into place. Repeat for the opposite side.
2. Slide the screen into the hangers (the hangers can be rotated out slightly to help get the screen frame in). Move the bottom of the screen in toward the window frame until it is against the stop.

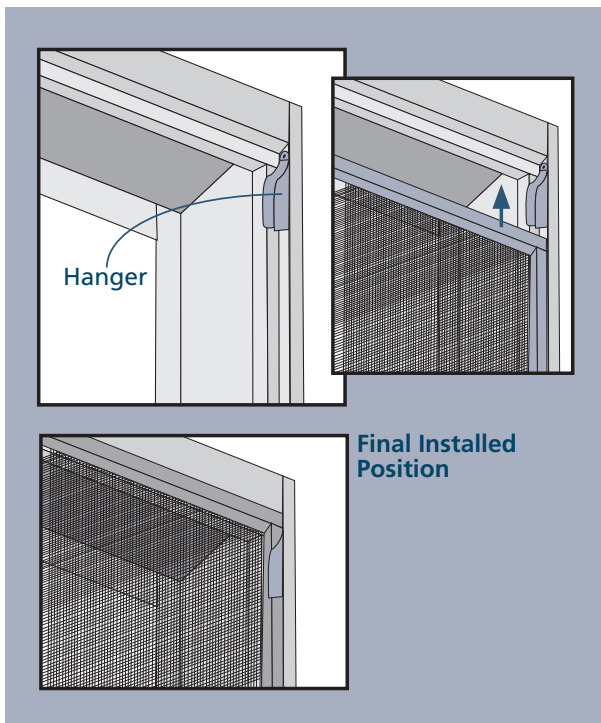

3. Hold the screen in place and extend the loops out toward the interior of the window frame and mark the location for the ball heads.
4. Fasten the ball heads into place with the screw and check for proper operation.

